

PRODUCT DESCRIPTION	
<p>StraightLine SEG display systems feature convenient tool-free assembly, durable light-weight frames, and silicone-edge graphics printed on exclusive One Planet recycled fabrics with impressive vivid graphics, all conveniently organized within molded inserts in a heavy-duty shipping case. Panel A features an interesting slanted shape, a wonderful accent when combined with other panels but also an effective exhibit on its own.</p> <p>Upgrade to double-sided graphics, mix-and-match with other StraightLine panels, or combine with WaveLine and BrightLine displays, to create unique branded environments. TV mounts and counters complete an enhanced experience to help brands stand out.</p>	

DISPLAY CONSTRUCTION	
Aluminum frame with aluminum support poles	

DIMENSIONS	
Assembled Unit	60" w x 89" h1 x 96" h2 x 4" d
Packed Case	46.5" w x 15" h x 12" d, 45 lbs
Shipping Box	47" w x 16" h x 13" d, 47 lbs
Graphic Size	60" w x 89" h1 x 96" h2

KEY FEATURES	
<ul style="list-style-type: none"> • Modular system • Easy tool free assembly • Lightweight portable construction 	<ul style="list-style-type: none"> • Heavy duty shipping case, molded foam inserts • Single- or double-sided • Vibrant graphics on recycled fabric

GRAPHIC MATERIAL	
<p>Graphic Print : Dye sublimated on One Planet, 100% recycled, fabric</p>	<p>Bottles recycled 42</p>

GRAPHIC FINISHING	
Silicone sewn edges	

WARRANTY	
<p>Limited Warranty Periods</p> <ul style="list-style-type: none"> - Frame : Lifetime - Graphics : 30 days 	

PARTS

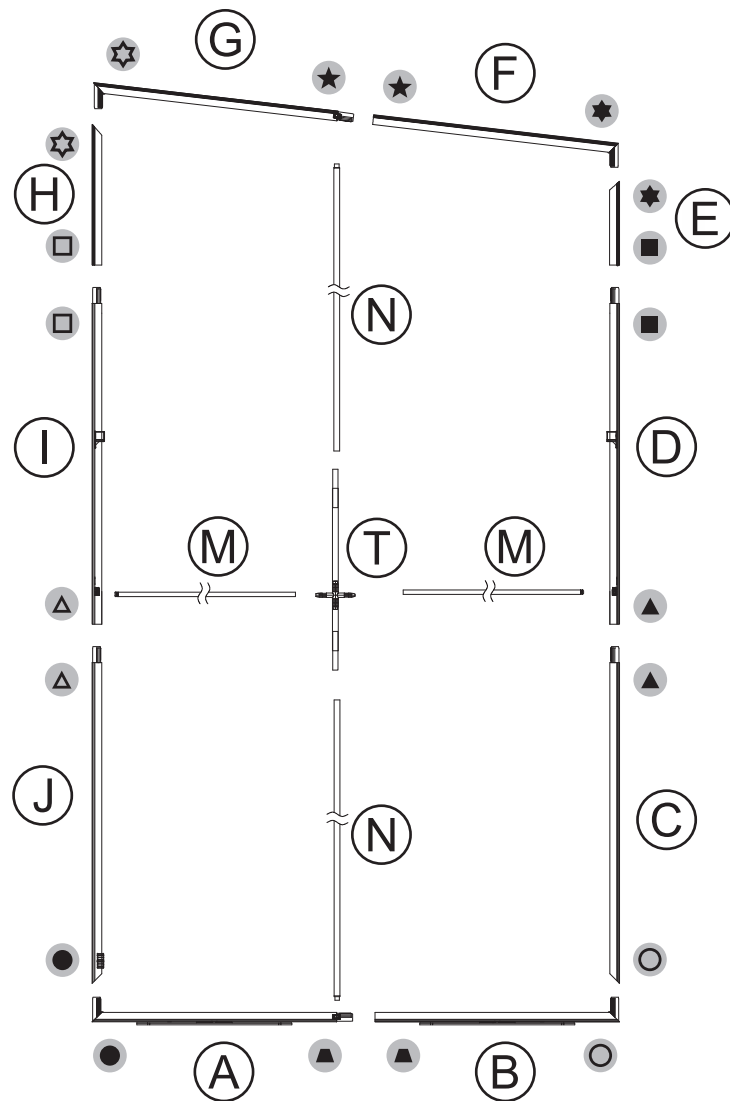
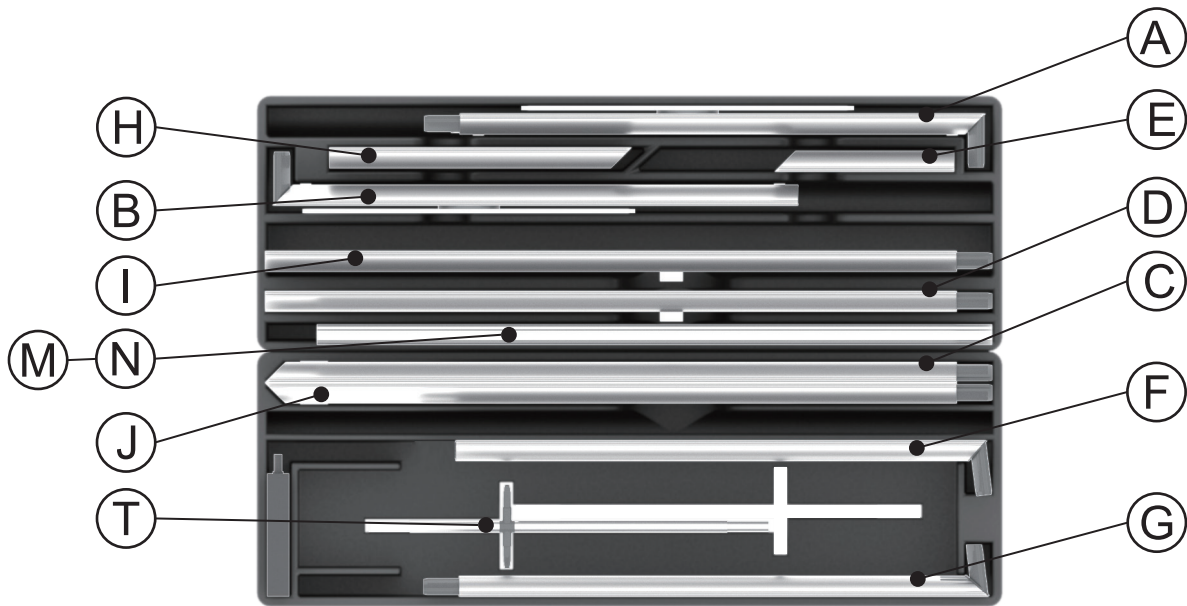

ASSEMBLY

Assemble parts on the floor and stand-up unit when completed.

1

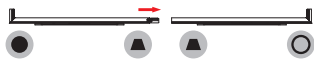
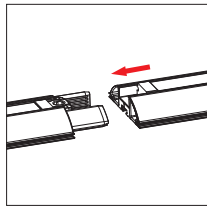

2

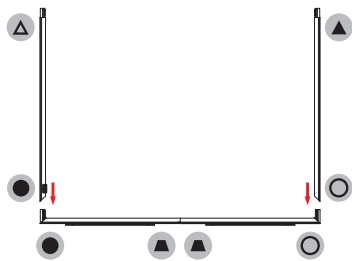
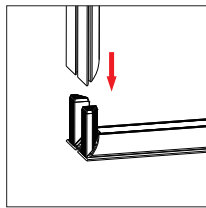

3

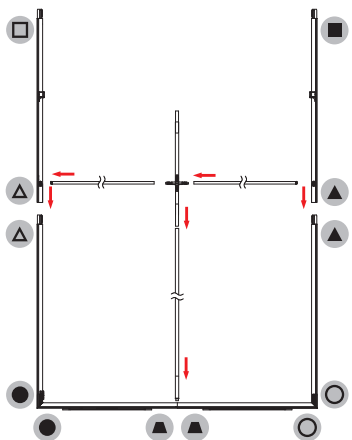
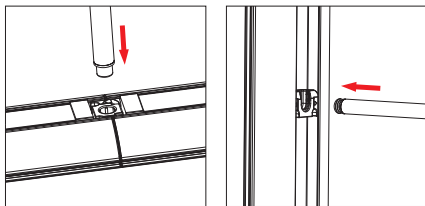

4

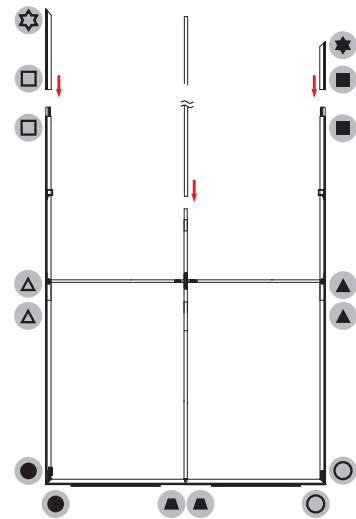
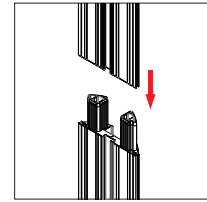

5

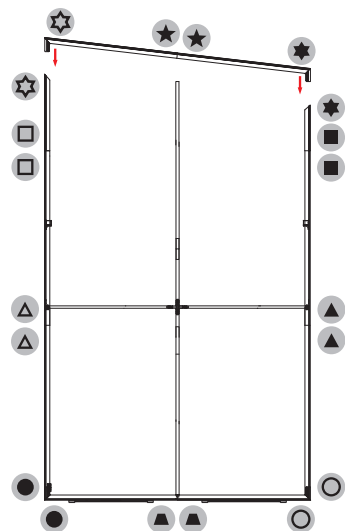
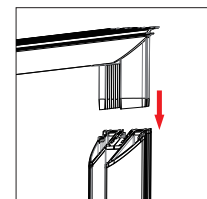

5 Push the silicone bead into each corner of the frame with your thumb.

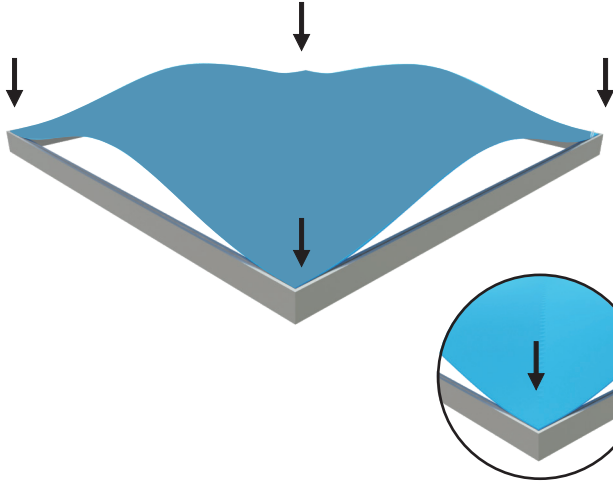

Push the silicone bead into the middle of the run and work your way around the perimeter of the frame until all beading is pushed in properly

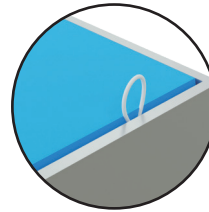
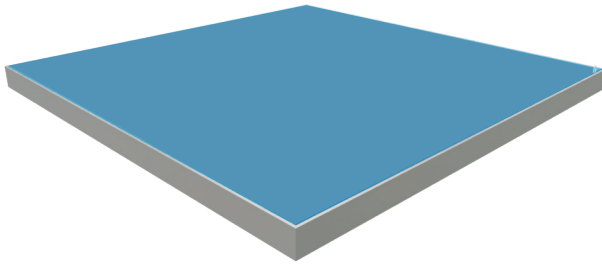
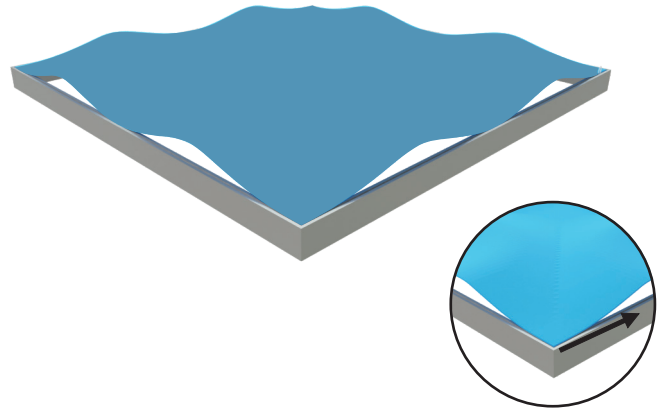

To Remove Graphic
Use the pull tab located on the graphic and gently pull the graphic from the frame, going around the perimeter

6

