

Esy TV Monitor Stand with Counter

To set up the frame according to the labellings.

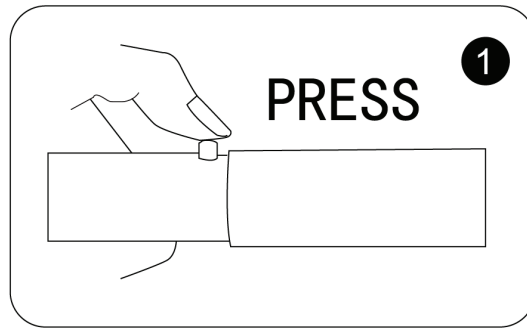

Connect frame sections by pressing the spring loaded buttons and sliding the two parts together.

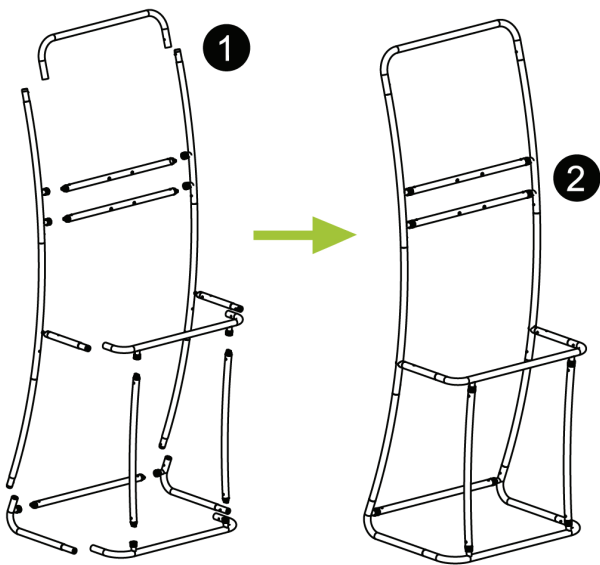
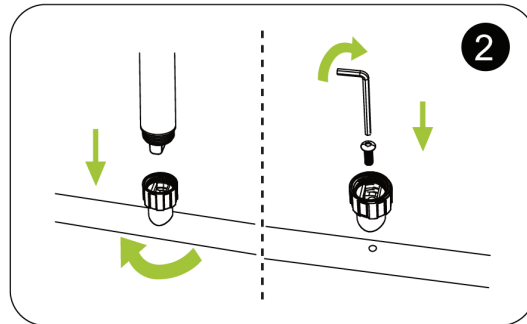

Locate hold in frame and screw in the plastic connection joint. Now connect the tube into the joint and tighten.

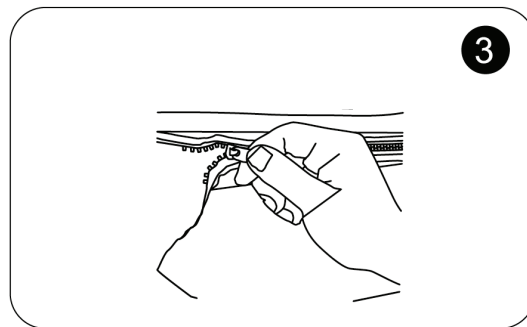
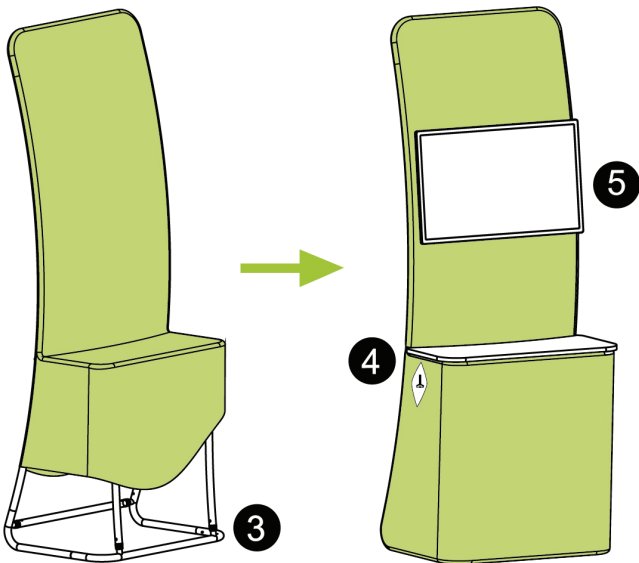

Slip the printed tension fabric cover over the frame from the top down.

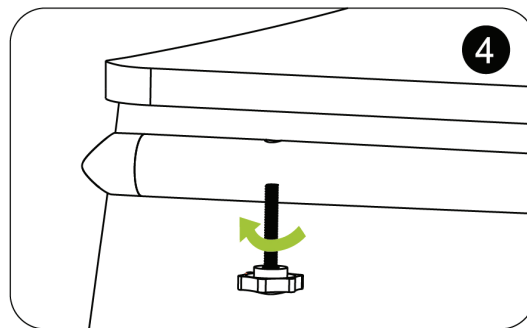

Connect table top to frame with the provided bolts.

