

MODCO22-20x10G

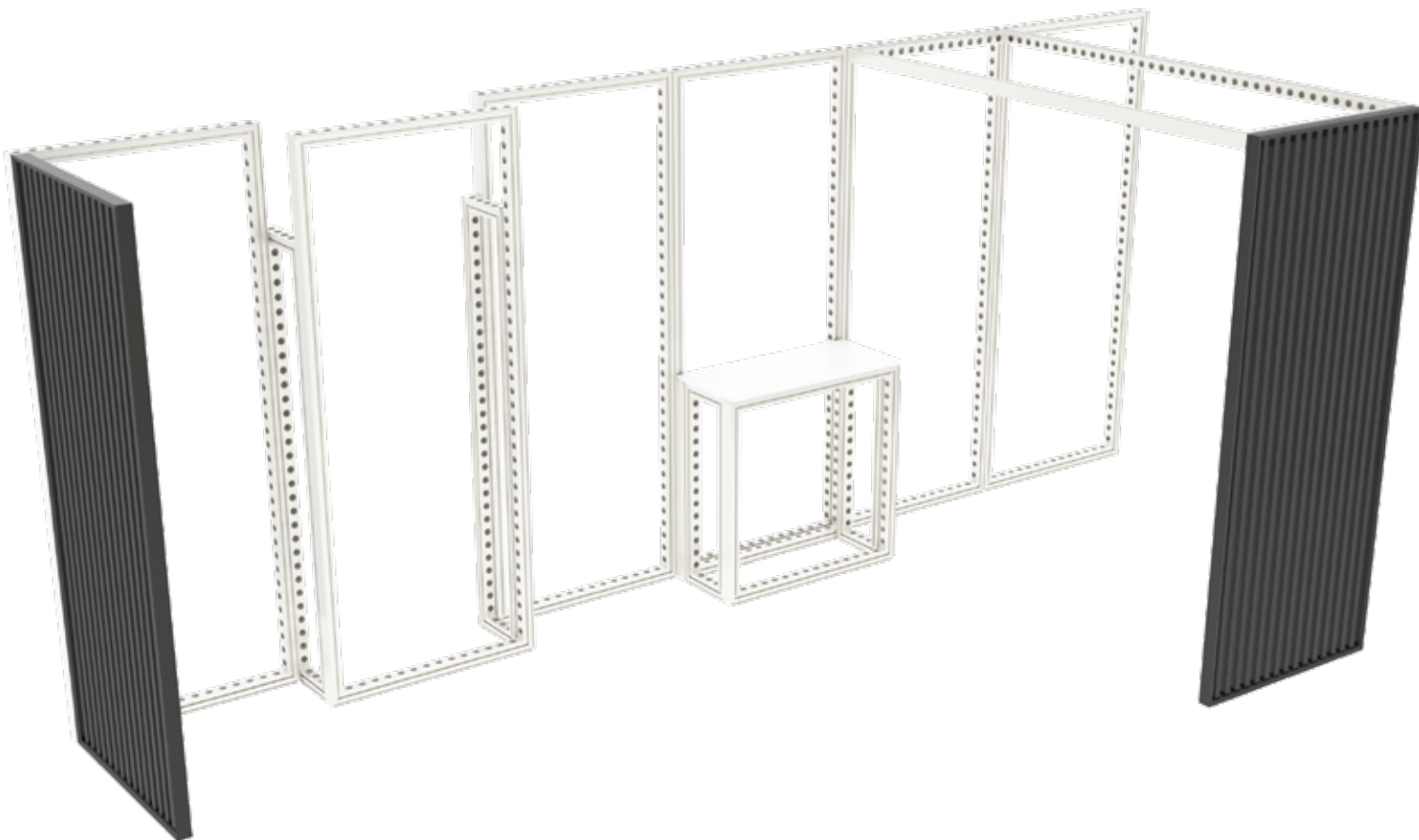

Name: Joey F.

Date: Jul 2 2024

SKU build: MODCO22-20x10G

Location: MX / PA

QC build: n/a (Standard)

PARTS LIST



MOD-FRM-992x2418
Qty.7



MOD-FRM-310x1984
Qty.2



MOD-FRM-310x992
Qty.2

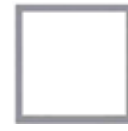

MOD-FRM-992x992
Qty.2



MOD-CTR-BM-992x434-WHT
Qty.1



MOD-FRM-992x2418-LV-BLK
Qty.2



MOD-SM90-LV-CON
Qty.2

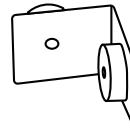

MOD-90D-CON
Qty.10

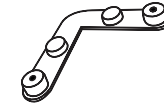

MOD-SM90D-CON
Qty.12

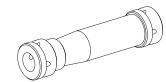

MOD-CLA-CON
Qty.6

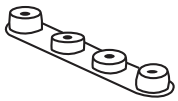

MOD-180D-CON
Qty.6



MOD-PC
Qty.56



MOD-CP-992x2418
Qty.5



MOD-CP-3100 (992mm)
Qty.4

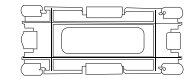

MOD-CC
Qty.33



MOD-PCWP-A
Qty.2

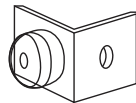

MOD-PNL-CON-LV
Qty.2

CONNECTIONS

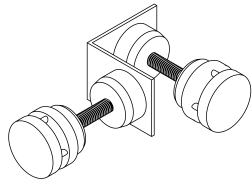

MOD-90D-CON + MOD-PC

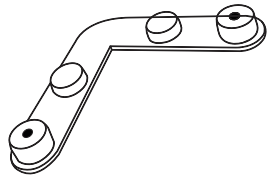
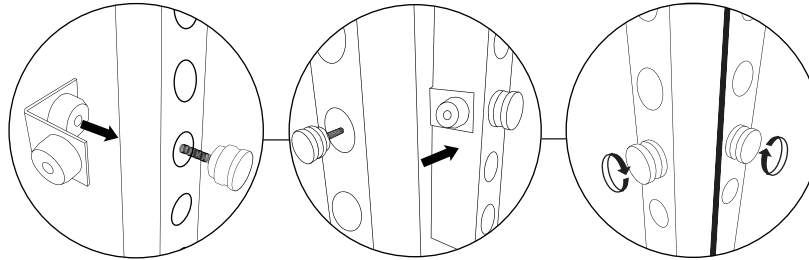

MOD-SM90D-CON / MOD-PC

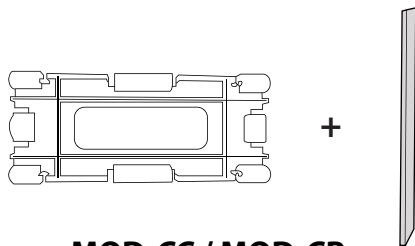
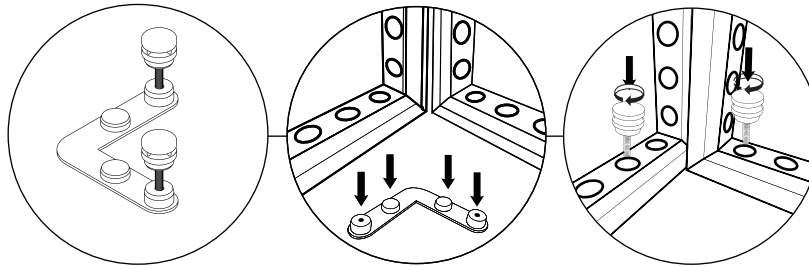

MOD-CC / MOD-CP

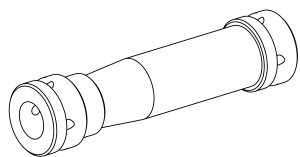
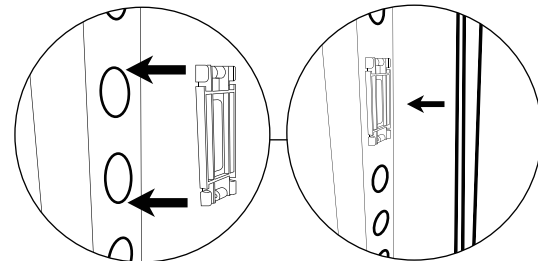

MOD-CLA-CON

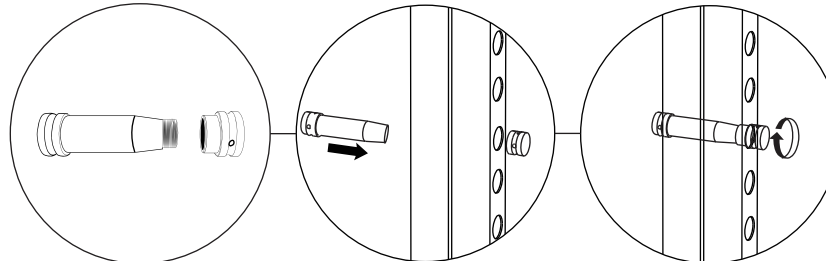

CONNECTIONS

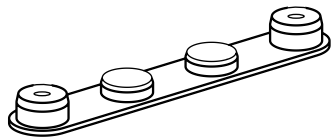

MOD-180D-CON / MOD-PC

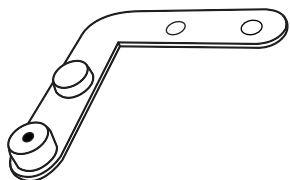
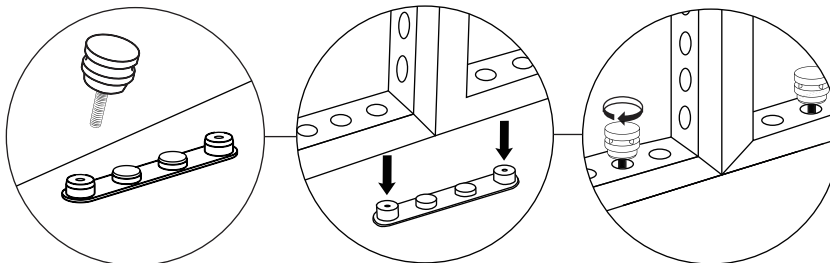

MOD-SM90-LV-CON / MOD-PC / WINGNUTS

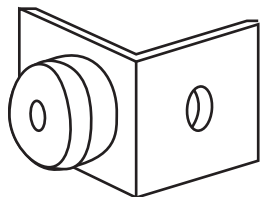
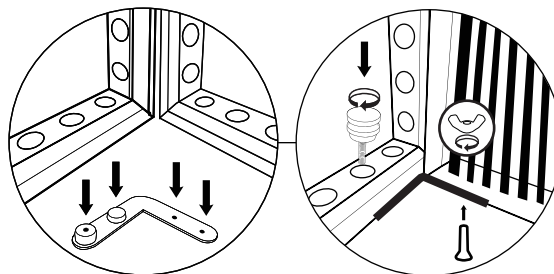

MOD-PNL-CON-LV / MOD-PCWP-A / WINGNUTS

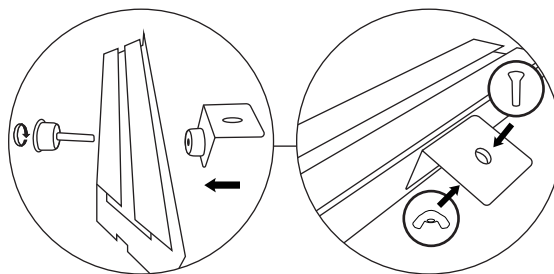

1

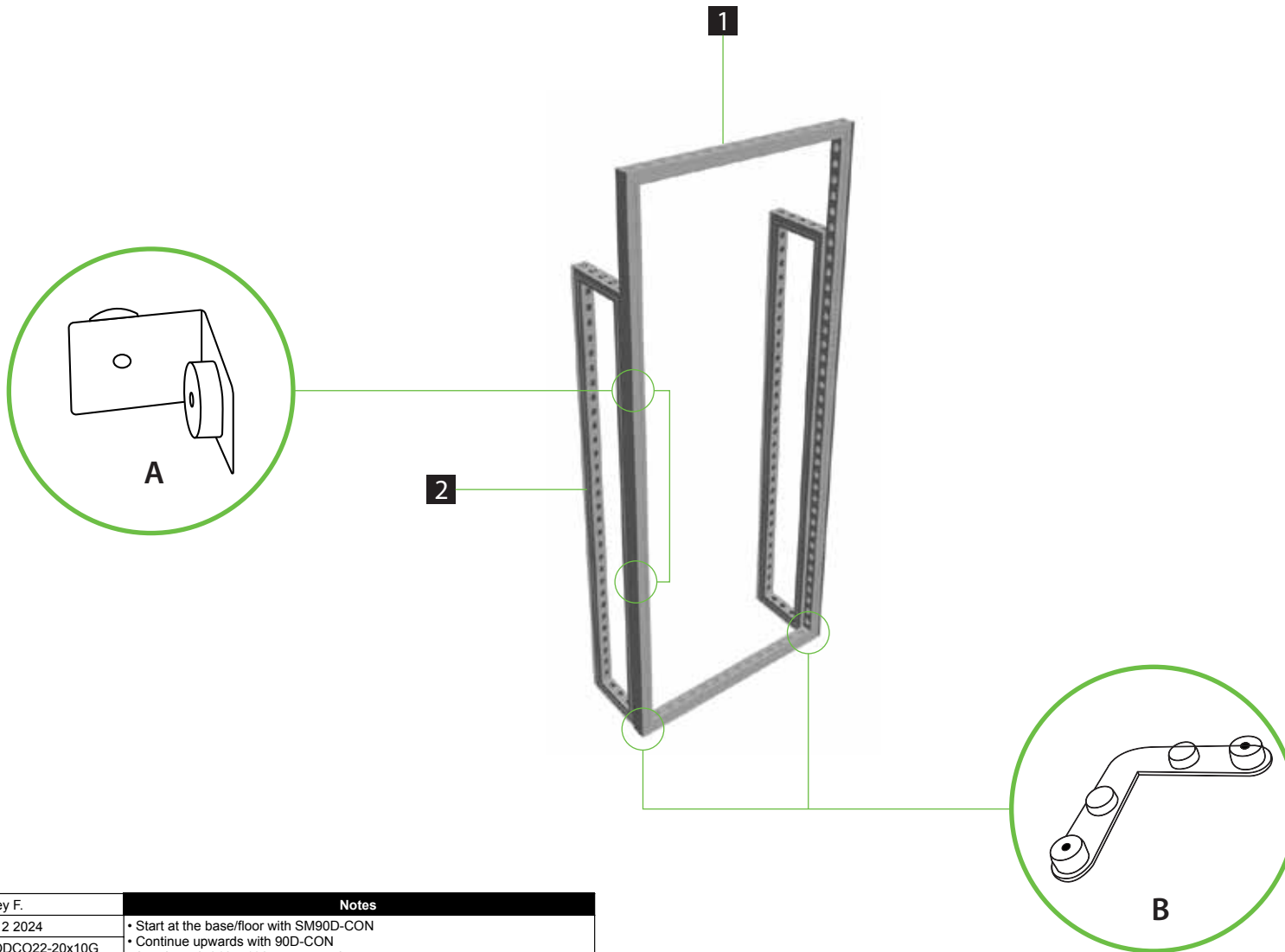

Name:	Joey F.	Notes
Date:	Jul 2 2024	<ul style="list-style-type: none"> • Start at the base/floor with SM90D-CON • Continue upwards with 90D-CON • Attach each 310 x 1984, one at a time • A & B both use the (C) connector - MOD-PC, to secure to the frame.
SKU build:	MODCO22-20x10G	
Location:	MX/PA	
QC build:	n/a (Standard)	

Step 1 PARTS LIST

REF	QTY	PART NO.	DESCRIPTION
1	1	MOD-FRM-992x2418	Straight Frame, Corner Screw Connect 992mm x 2418mm
2	2	MOD-FRM-310x1984	Straight Frame, Corner Screw Connect 310mm x 1984mm
A	4	MOD-90D-CON	90°Connector
B	2	MOD-SM90D-CON	90°Connector
C	12	MOD-PC	Pin Connector

2

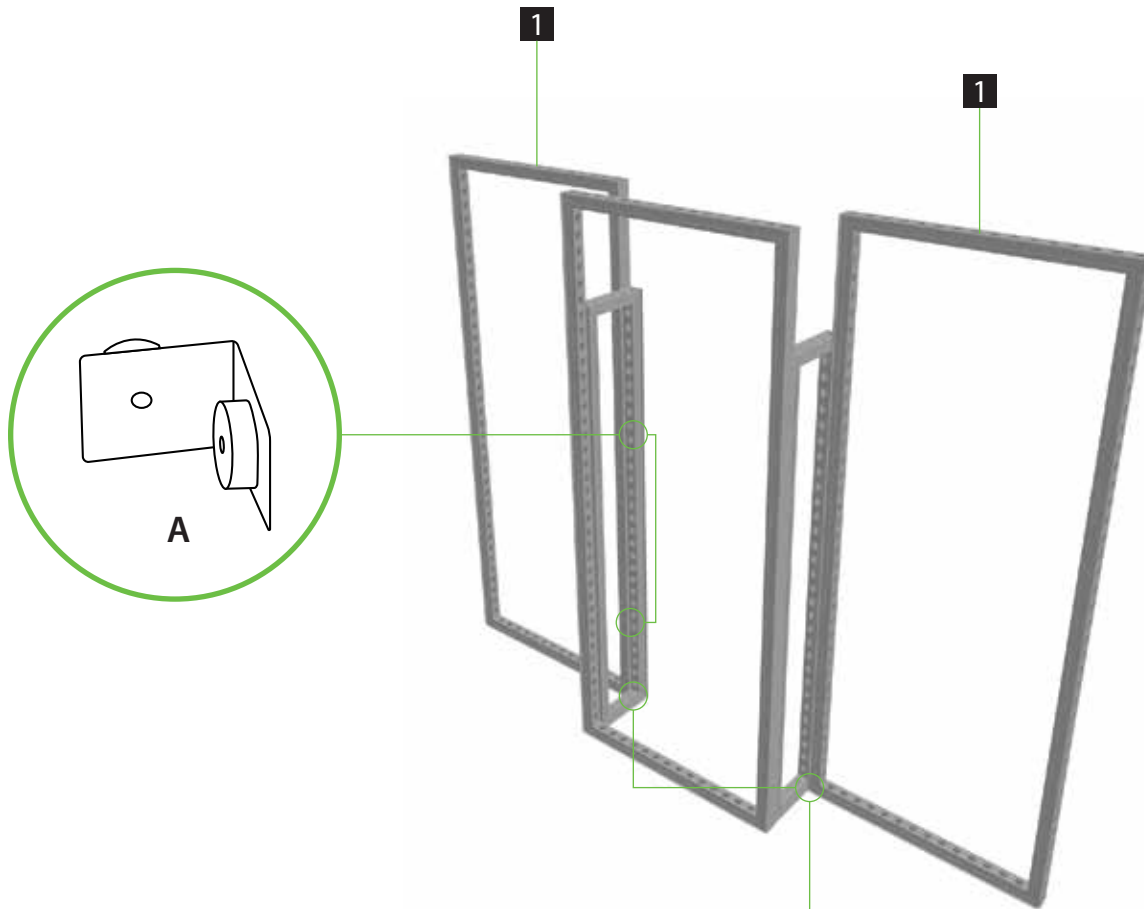

Name:	Joey F.	Notes	
Date:	Jul 2 2024	• Add 992 x 2418 to each side	
SKU build:	MODCO22-20x10G		
Location	MX / PA		
QC build:	n/a (Standard)		
Step 2 PARTS LIST			
REF	QTY	PART NO.	DESCRIPTION
1	2	MOD-FRM-992x2418	Straight Frame, Corner Screw Connect 992mm x 2418mm
A	4	MOD-90D-CON	90° Connector
B	2	MOD-SM90D-CON	90° Connector
C	12	MOD-PC	Pin Connector

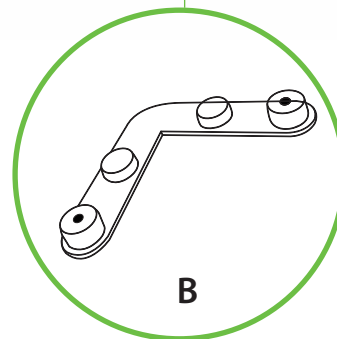

3

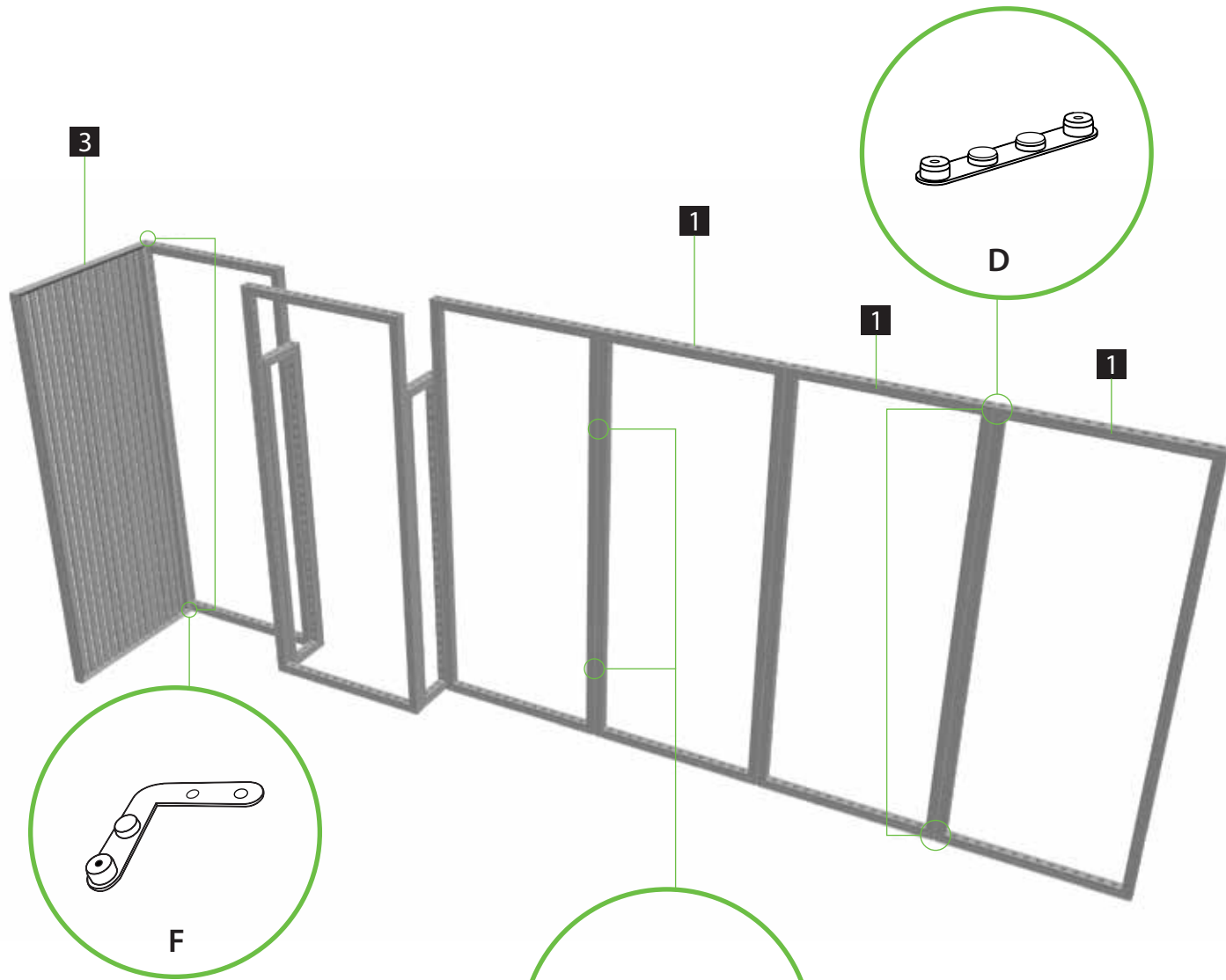

Name:	Joey F.	Notes
Date:	Jul 2 2024	• Use wingnuts/bolts for Louver hardware connection.
SKU build:	MODCO22-20x10G	
Location:	MX / PA	
QC build:	n/a (Standard)	

Step 3 PARTS LIST			
REF	QTY	PART NO.	DESCRIPTION
1	3	MOD-FRM-992x2418	Straight Frame, Corner Screw Connect 992mm x 2418mm
3	1	MOD-FRM-992x2418-LV-BLK	Modco Louver Frame, 992mm x 2418mm
C	12	MOD-PC	Pin Connector
D	6	MOD-180D-CON	Modco 180° Connector
E	6	MOD-CLA-CON	Modco Clamp Connector
F	2	MOD-SM90-LV-CON	90 degree connector, for Louver to M frame

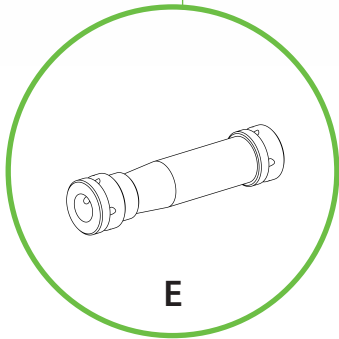

4

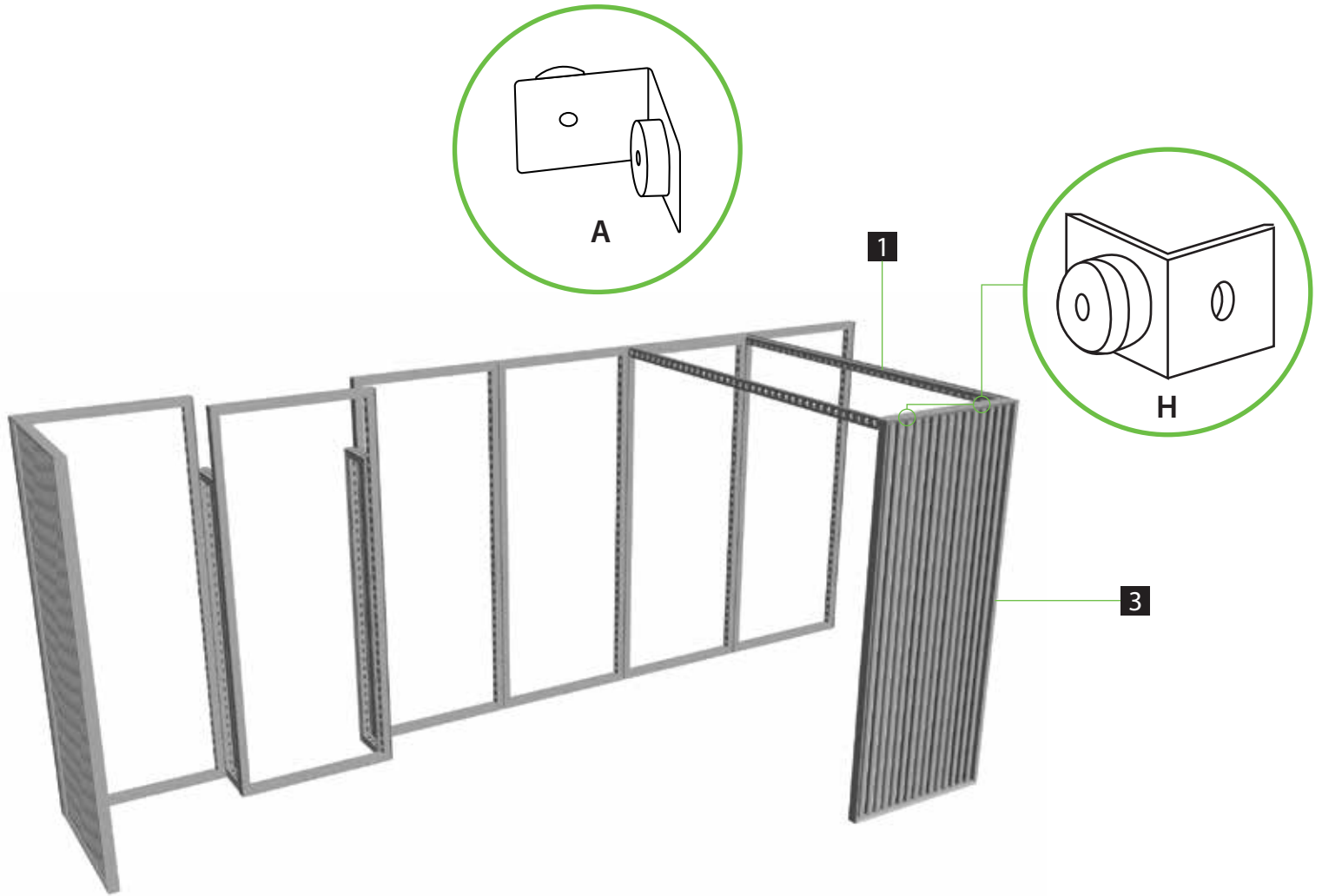

Name:	Joey F.	Notes
Date:	Jul 2 2024	• Use wingnuts/bolts for Louver hardware connection.
SKU build:	MODCO22-20x10G	
Location:	MX / PA	
QC build:	n/a (Standard)	

Step 4 PARTS LIST			
REF	QTY	PART NO.	DESCRIPTION
1	1	MOD-FRM-992x2418	Straight Frame, Corner Screw Connect 992mm x 2418mm
3	1	MOD-FRM-992x2418-LV-BLK	Modco Louver Frame, 992mm x 2418mm
A	2	MOD-90D-CON	Modco 90° Connector
C	4	MOD-PC	Pin Connector
G	2	MOD-PCWP-A	Modco Flat Head Pin Connector
H	2	MOD-PNL-CON-LV	Modco Panel Connector to Louver

5

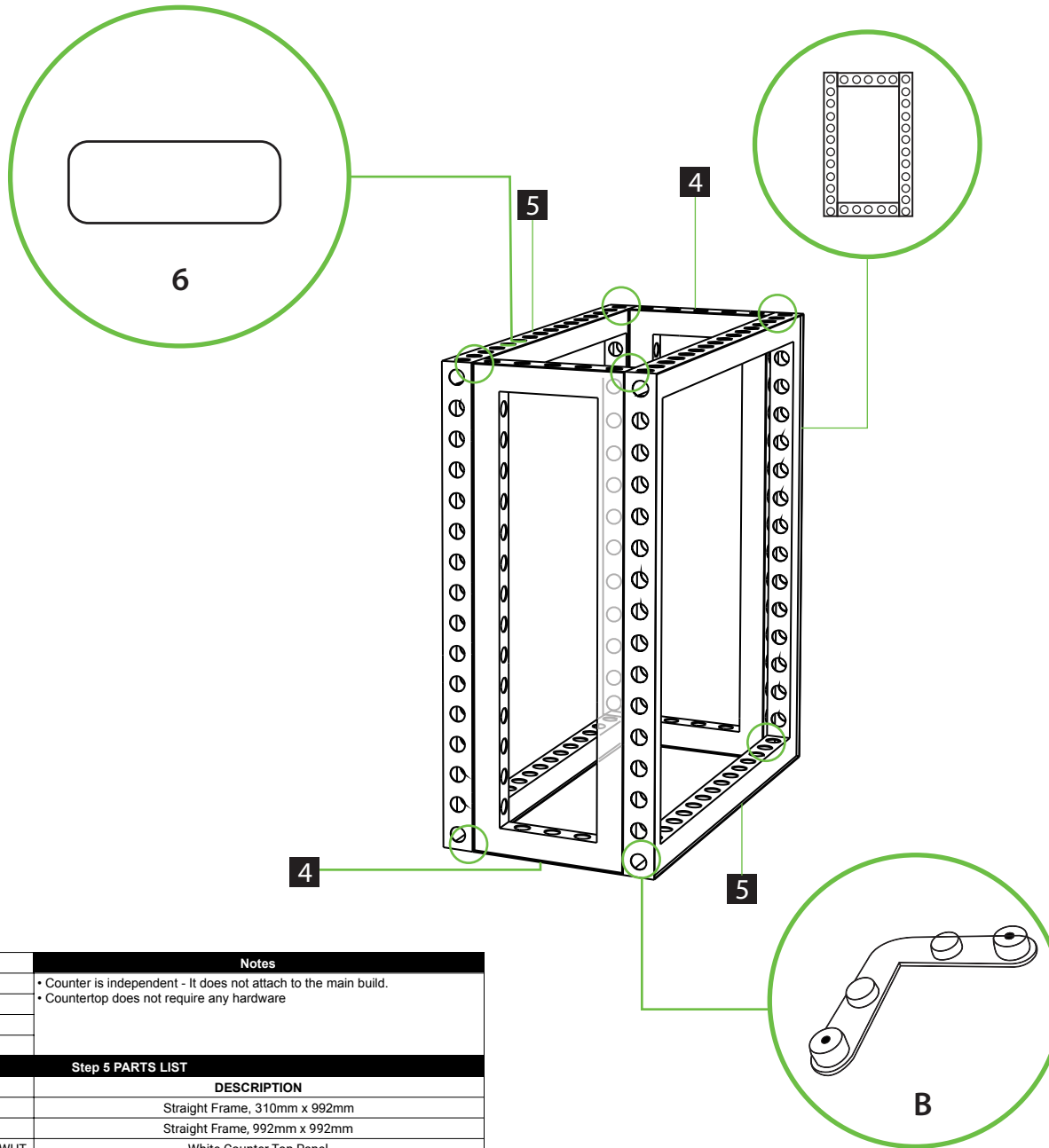

Name:	Joey F.	Notes	
Date:	Jul 2 2024	• Counter is independent - It does not attach to the main build. • Countertop does not require any hardware	
SKU build:	MODCO22-20x10G		
Location:	MX / PA		
QC build:	n/a (Standard)		
Step 5 PARTS LIST			
REF	QTY	PART NO.	DESCRIPTION
4	2	MOD-FRM-310x992	Straight Frame, 310mm x 992mm
5	2	MOD-FRM-992x992	Straight Frame, 992mm x 992mm
6	1	MOD-CTR-BM-992x434-WHT	White Counter Top Panel
B	8	MOD-SM90D-CON	L-Shaped 90° Connector
C	16	MOD-PC	Pin Connector

6

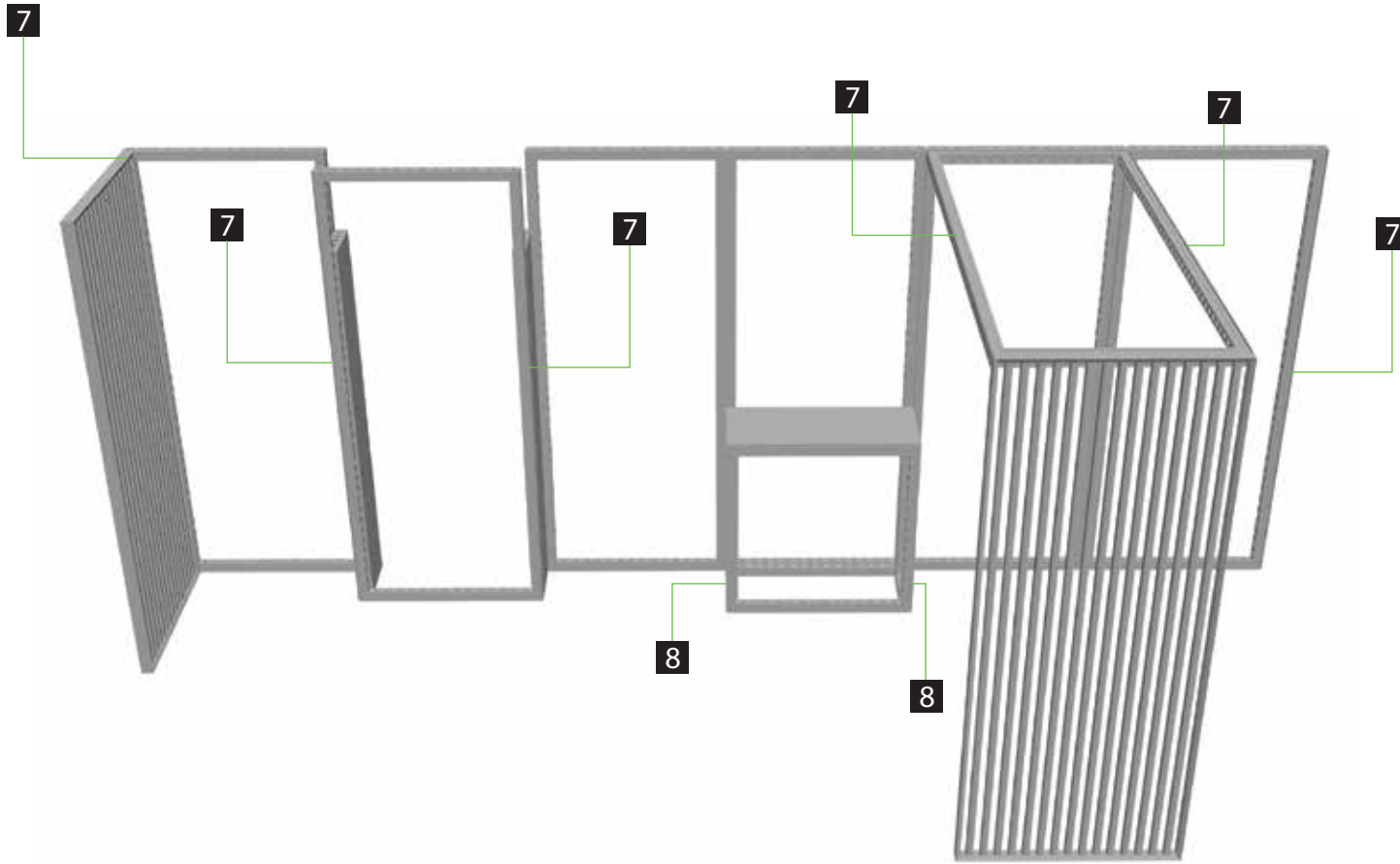

Name: Joey F.		Notes	
Date: Jul 2 2024		• Use (I) or MOD-CC to attach the cover profiles to the frame.	
SKU build: MODCO22-20x10G			
Location: MX / PA			
QC build: n/a (Standard)			
Step 6 PARTS LIST			
REF	QTY	PART NO.	DESCRIPTION
7	5	MOD-CP-992x2418	Cover Profile 992mm (Total of 4)
8	4	MOD-CP-3100 (992mm)	Cover Profile 992mm (Total of 4)
I	33	MOD-CC	Cover Profile Clip Connector

Graphic Reference

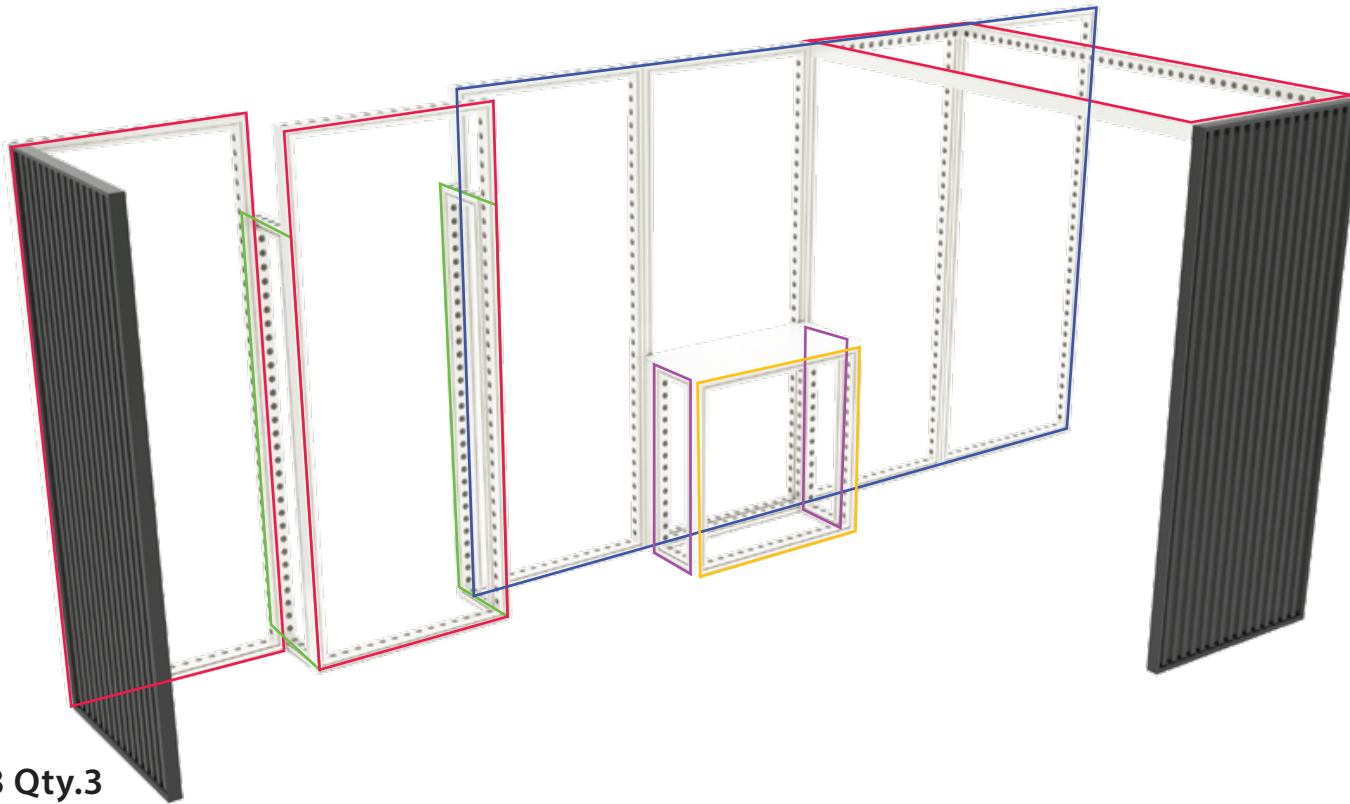

992 x 2418 Qty.3



310 x 1984 Qty.2



3968 x 2418 Qty.1



992 x 992 Qty.1



310 x 992 Qty.2

Graphic Install



Place graphic over the front of the frame.



Begin inserting SEG beading at each corner.

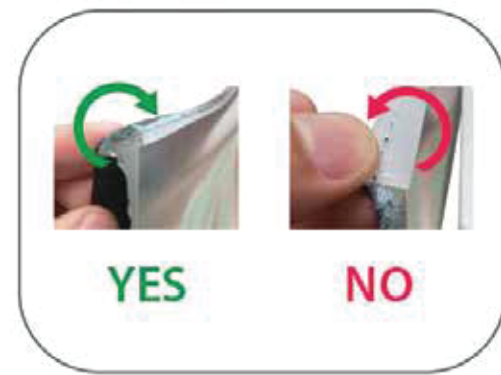

Insert the silicone beading with the fabric folded over. The silicone beading should not be exposed.

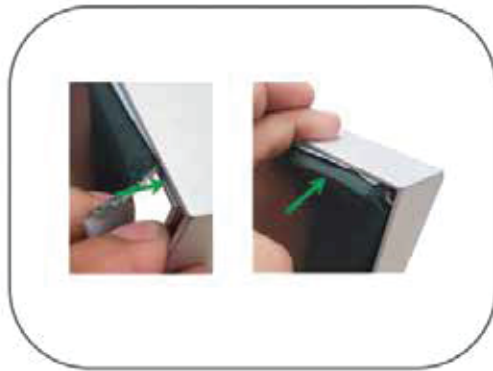

Using your fingers, push both fabric and silicone beading completely into the extrusions channel.



Continue to push in the remaining silicone beading on each side.



Check the perimeter of the frame for any excess beading that hasn't been pushed in. Graphic should be taut.